

STREAMING VIDEO DRONE WITH FPV HEADSET

POWERING UP AND PAIRING



Insert fully charged LiPo battery into the underside of drone, then connect the battery to back of the drone. [See reverse.]



Place the drone on level surface for calibration.



Turn on controller. (Before initial use, install new batteries into controller. See reverse.)



Remove plastic film from lens before use. Once lights turn solid, drone is ready to fly.

BASIC FLIGHT MANEUVERS

To make flying easier, place the drone on the ground in front of you with the drone facing away from you (green blades forward). You should be facing the same way the drone is facing.

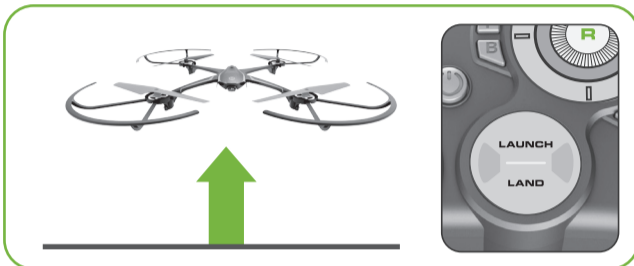

Press **LAUNCH** to automatically launch a few feet off the ground.

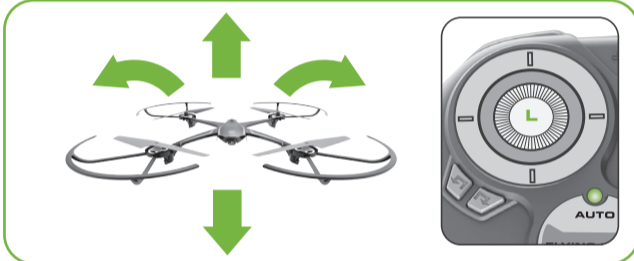

Move **LEFT (Throttle)** thumbstick up or down to make drone fly higher or lower and left or right to rotate.

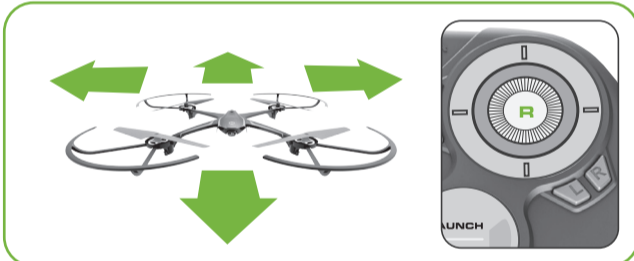

Use **RIGHT (Directional)** thumbstick to fly forward, backward, left or right.

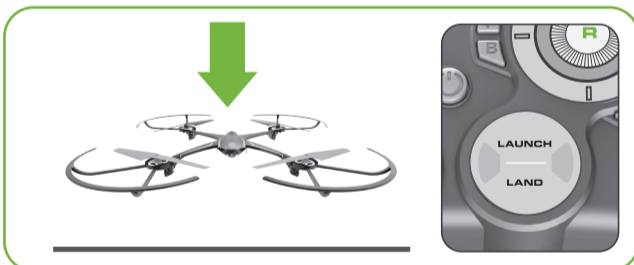

Press **LAND** to automatically land.

Alternatively you can use the left thumbstick to land the drone. Hold the left thumbstick all the way down for about 1 second after the drone has safely reached the ground, and the motors will stop spinning.

FLIGHT CONTROLS

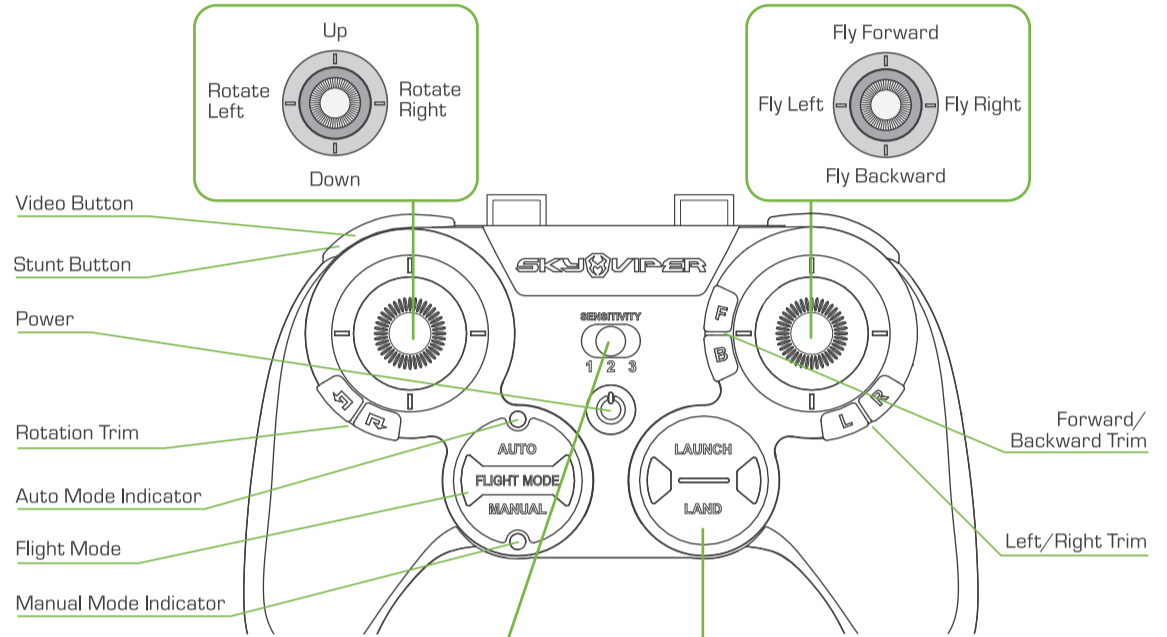

FLIGHT SENSITIVITY SWITCH



It is best to start with **LOW** sensitivity until you master flying.

LAUNCH/LAND BUTTON



• Reset drone WiFi password: Hold L Trim, R Trim and Power for 3 seconds. (Controller and drone must be paired)

• Reset controller to factory settings: Hold F Trim, B Trim, and Power for 3 seconds.

⚠ If for any reason you need to immediately stop the drone, hold down the stunt button (for drones that don't have a stunt button, use the video button) and move both thumbsticks down and away from the center of the controller.

STREAMING AND RECORDING VIDEO WITHOUT THE HEADSET

LIVE STREAMING AND RECORDING

Download the **SKY VIPER VIDEO VIEWER** app from the App Store or Google Play. Follow the instructions in the app to stream and/or record video and take photos.



RECORDING HIGHER QUALITY VIDEO TO MICRO SD CARD

(MICRO SD CARD SOLD SEPARATELY)

To record video in 720p insert Micro SD card (sold separately) into the back of drone. Follow the instructions in the app to toggle recording to your mobile device or your Micro SD card. Record directly to the Micro SD card without the app by using the button on the controller.



AUTO AND MANUAL FLIGHT MODES

AUTO mode is best for new pilots. Begin by pressing the Launch button for takeoff. The drone will hold its altitude, and gradually fly up or down when you press up or down on the left thumbstick.

MANUAL mode is better for experienced pilots. When the left thumbstick is pushed all the way up the drone will spin its motors as fast as it can while maintaining stability, and when the left thumbstick is pushed all the way down the motors will stop spinning.



USING THE FPV (First Person View) HEADSET

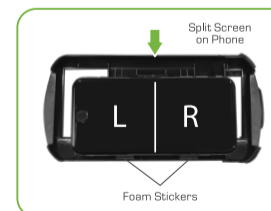

- Before inserting your phone, put the headset on and adjust the straps as necessary to ensure a snug and secure fit.
- Once adjusted, slide out smart phone tray from headset.
- Power up your drone and select the Sky Viper Video Viewer app on your smart phone. Follow the on-screen instructions and select the FPV viewing option.
- Insert your smartphone into the tray by securely positioning it under the clamp and align the middle of the phone with the midline on the tray clamp. NOTE: You may need to adhere included Foam Stickers to the tray to prevent the clamp from pressing down on your smartphone's side buttons.
- Slide tray back into headset.
- Adjust lenses by moving the sliders forward and back and side to side. Keep adjusting and trying different positions until the screen image is in focus.

CAUTION: NEVER WALK AROUND WHEN WEARING THE FPV HEADSET. Be aware of your surroundings and any potential hazards before putting the headset on. Always use common sense and good judgment.

STREAMING VIDEO DRONE WITH FPV HEADSET

ADJUSTABLE CAMERA ANGLE

The drone camera angle is adjustable to suit your preference. Recommended position is pointing slightly downward.

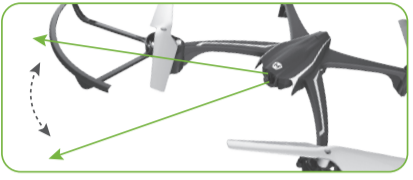

BATTERY UPGRADE

Double your flying time with an additional battery!

Details of how to purchase additional or replacement battery packs available at SKYVIPER.COM

#01739

CONTENTS

- Streaming Video Drone
- USB Charging Cable
- Rechargeable 3.7V 650 mAH LiPo Battery
- Controller
- Phone Mount
- 4 Replacement Blades
- 4 Blade Guards
- Screwdriver & Extra Screws
- 2 Pro Style Thumbsticks
- FPV Headset
- Foam Stickers

SKY VIPER FLIGHT SIMULATOR

Learn and practice maneuvers on your phone, then apply your new skills in real life.



Download on the App Store

ANDROID APP ON Google Play

FAILSAFE GUIDE



When the drone turns upside down, the motors will stop spinning.



When the drone goes out of range of the controller, it will automatically land itself in its current position. If the controller comes back in to range before the drone lands, it is possible to cancel this automatic landing by pressing up on the throttle.



When the drone's battery is at 10% or less, the LEDs on the drone will begin to blink rapidly, and a tone is played continuously on the controller until the controller and drone are turned off.



When the drone's battery is depleted, the drone will automatically land itself in its current position. This automatic landing cannot be interrupted with the controller.

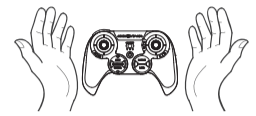

If the drone detects that no input has been received by the controller for 15 seconds, the drone will automatically land itself in its current position.

TRIM ADJUSTMENTS



IF THE DRONE DRIFTS FORWARD: Press "B" button several times until the drone stops drifting forward.

IF THE DRONE DRIFTS BACKWARD: Press "F" button several times until the drone stops drifting backward.



IF THE DRONE DRIFTS LEFT: Press "R" button several times until the drone stops drifting left.

IF THE DRONE DRIFTS RIGHT: Press "L" button several times until the drone stops drifting right.



IF THE DRONE SPINS COUNTER-CLOCKWISE (VIEWED FROM ABOVE): Press the [R] button several times until the drone stops spinning.

IF THE DRONE SPINS CLOCKWISE (VIEWED FROM ABOVE): Press the [L] button several times until the drone stops spinning.

TIPS:

#1: When the controller LED flashes 3 times quickly, the trim is at middle of trim range.

#2: If you are uncomfortable trimming the drone in flight, you can land onto a flat surface and make your trim adjustments.

#3: To reset trim adjustments, hold the [R] and the [L] buttons down for 2 seconds.

CONTROLLER MODE SET-UP

When the controller is OFF, press and hold the flight mode button, LAUNCH/LAND button, and POWER button for three seconds to toggle between mode 1 and mode 2.

Mode 2 (default, most commonly used) LEFT thumbstick makes the drone go up/down, and rotate clockwise/counter-clockwise. RIGHT thumbstick makes the drone fly forward, backward, left, and right.

Mode 1 (used in Australia and most Asian & European countries) LEFT thumbstick makes the drone fly forward/backward, and rotate clockwise/counter-clockwise. RIGHT thumbstick makes the drone go up/down, and fly left and right.

ONE TOUCH STUNTS

NOTE:

Once a stunt has been initiated, DO NOT adjust Throttle or press any other controls until the stunt has been completed.

BARREL ROLL LEFT OR RIGHT

While flying forward (or reverse), tap the STUNT button.

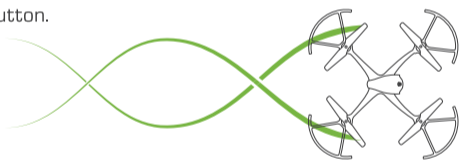

FLIP IN 4 DIRECTIONS

- 1 Bring the drone to a mid-air hover without flying in any direction. Remove finger from the RIGHT thumbstick.
- 2 While hovering, press and hold the STUNT button.
- 3 Then quickly tap the RIGHT thumbstick in the direction you want the drone to flip.

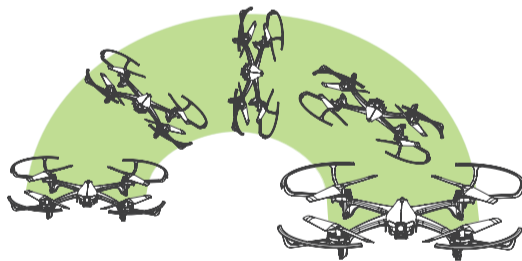

CAUTION!

The drone should be flying at least 6 feet in the air with a minimum clearance of 6 feet in all directions before attempting stunt functions.

REPLACING DAMAGED BLADES

Use the included screwdriver to unscrew the propeller, then pull up on propeller to detach. Match A propellers to A legs and B propellers to B legs. Replace screws and tighten. See image to right.

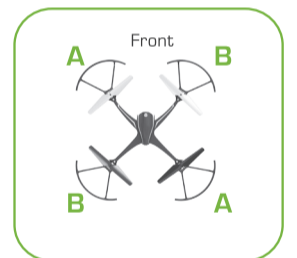
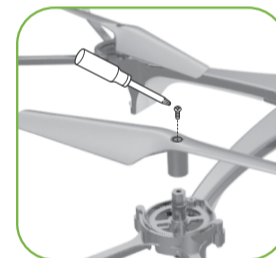

INSTALLING BATTERIES IN THE CONTROLLER

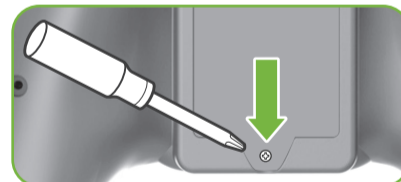

*Screwdriver not included.



*Batteries not included.

WE'RE HERE TO HELP!

For questions about this product:

Online: skyviper.com/support

Email: support@skyrockettoys.com

Phone: 1-888-674-5650 M-F 9am to 6pm PST

ADULT SUPERVISION REQUIRED

Before each use, an adult should check this product and the LiPo battery to ensure no damage or hazards exist. Drone has rotating blades that move at high speed, posing danger of damage and injury. Use of included blade guards strongly recommended. Pilots are responsible for any actions that result in damage or injury from the improper operation of drone. Adequate flying space is required. Avoid flying near interior fans and/or vents as they may make flying difficult to control. Keep a safe distance away from streets, public thoroughfares and power lines. Never attempt to retrieve drone from any location higher than your reach (such as rooftops or trees) or from any location that poses a safety hazard. Never fly drone at night. Keep drone in sight at all times during operation. Discontinue operation immediately if drone flies out of your field of view. Do not fly near spectators or animals. Keep spinning rotors away from fingers, hair, eyes and other body parts. Always launch from a flat surface. Never leave drone unattended while it is turned on. Read all enclosed information before operating.

CHARGING THE LiPo BATTERY

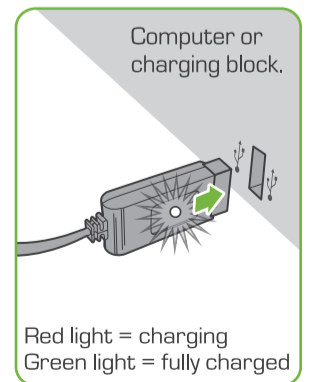
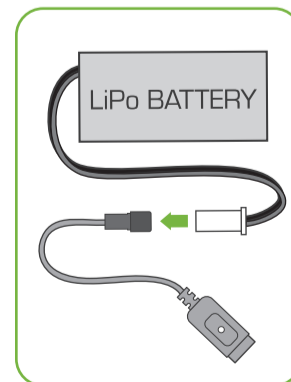
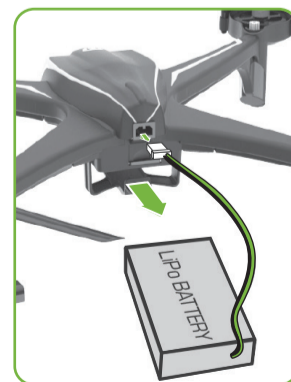

Red light = charging
Green light = fully charged

CHARGING PRECAUTIONS:

- After use, allow drone (battery on bottom) to cool down to room temperature before charging again.
- Charge battery in an isolated area, away from excessive heat or moisture.
- If you suspect that the battery is damaged or swelling, discard the battery in accordance with your country's recycling laws.
- Do not modify, heat, or wet the battery in any way. Only recharge with provided charger.

STREAMING VIDEO DRONE WITH FPV HEADSET

PLEASE READ SAFETY WARNINGS CAREFULLY BEFORE USING THE FPV HEADSET:

BEFORE USING FPV HEADSET:

- Read and follow all setup and operating instructions provided with the headset.
- We recommend seeing a doctor before using the headset if you are elderly, or suffer from a heart condition or other serious medical condition.

SEIZURE WARNING: Some people may have severe dizziness, seizure, epileptic seizures or blackout triggered by light flashes or pattern, and this may occur while they are watching TV, playing video games or experiencing virtual reality even if they have never had a seizure or blackout before or have no history or seizures or epilepsy. Anyone who has had a seizure, loss of awareness or other symptoms linked to an epileptic condition should see a doctor before using the headset.

USE ONLY IN A SAFE ENVIRONMENT: The headset produces an immersive experience that distracts you from and completely blocks your view of your actual surroundings. Always be aware of your surroundings when using the headset. **Remain seated** and take special care to ensure that you are not near other people, objects, stairs, balconies, windows, furniture, or other items that you can trip over, bump into, or knock down when using- or immediately after using- the headset. Do not handle sharp or otherwise dangerous objects while using the headset. Never wear the headset in situations that require attention, such as walking, bicycling or driving.

- Ease into the use of the headset to allow your body to adjust. Limit initial use to a few minutes at a time. Gradually increase usage as you grow accustomed to wearing the headset.
- Do not use the headset when you are tired or need sleep, as this can increase your susceptibility to adverse symptoms.
- Take a 10-15 minute break every flight, even if you don't think you need it. Each person is different, so take more frequent and longer breaks if you feel discomfort. You should decide what works best.

IF YOU EXPERIENCE DISCOMFORT: Immediately discontinue use if anyone using the headset experiences any of the following symptoms: seizures, loss of awareness, eye or muscle twitching, involuntary movement, altered, blurred or double vision, feeling detached from your body or from reality, dizziness, disorientation, disrupted balance, nausea, light-headedness, discomfort or pain in the head or eyes, drowsiness, fatigue or any symptoms similar to motion sickness.

PLEASE READ SAFETY WARNINGS CAREFULLY BEFORE USING THE FPV HEADSET

THIS PRODUCT CONTAINS A LITHIUM-POLYMER BATTERY 3.7V 650mAh:

LiPo batteries have a severe risk of fire and injury if they are improperly handled or misused. They may explode, overheat or ignite. Read all following precautions and instructions regarding the care and use of LiPo batteries.

The LiPo battery is only to be used with the drone and charger included with this product.

- Keep away from flammable materials.
- Do not expose to direct sunlight.
- Do not place in fire or leave in hot places.
- Do not drop or make subject to strong impact.
- Keep dry and away from water.
- Remove exhausted battery as soon as possible and discard properly.
- Remove battery from the compartment if toy is not used for a long period of time.
- The supply terminals are not to be short circuited.
- Never throw battery in a fire or attempt to open outer casing.
- Do not leave battery connected to drone when not in use.

LiPo Battery Disposal: LiPo batteries must be recycled or disposed of properly. They should not be disposed of with other household waste. Check your local laws and regulations for correct recycling and/or battery disposal.

AAA BATTERY CAUTIONS

- Do not use rechargeable batteries.
- Different types of batteries or new and old batteries are not to be mixed.
- Batteries are to be inserted using correct polarity.
- Remove exhausted batteries as soon as possible and discard properly.
- Remove all batteries from compartment if toy is not used for a long period of time.
- Never throw batteries in a fire or attempt to open the outer casing.
- Non-rechargeable batteries are not to be recharged.
- The supply terminals are not to be short circuited.
- Batteries should be replaced by an adult.

WARNING: Batteries are harmful if swallowed. Please keep away from children.

Battery Disposal: Dispose of batteries according to the local laws and regulations of your region. Some batteries may be recycled, and may be accepted for disposal at your local recycling center. If you are not able to identify the applicable rules in your area, please check the instructions of the battery manufacturer.

This device complies with PART 15 of the FCC Rules. Operation is subject to the following two conditions. (1) This device may not cause harmful interference, and (2) this device must accept any interference received, including interference that may cause undesired operation.

CAUTION: Changes or modifications to this unit not expressly approved by the party responsible for compliance could void the user's authority to operate the equipment.

NOTE: This equipment has been tested and found to comply with the limits for a Class B digital device, pursuant to Part 15 of the FCC Rules. These limits are designed to provide reasonable protection against harmful interference in a residential installation. This equipment generates, uses and can radiate radio frequency energy and, if not installed and used in accordance with the instructions, may cause harmful interference to radio communications. However, there is no guarantee that interference will not occur in a particular installation. If this equipment does cause harmful interference to radio or television reception, which can be determined by turning the equipment off and on, the user is encouraged to try to correct the interference by one or more of the following measures: Reorient or relocate the receiving antenna - Increase the separation between the equipment and receiver - Connect the equipment into an outlet on a circuit different from that to which the receiver is connected - Consult the dealer or an experienced radio/TV technician for help.

Remove all packaging attachments before giving the toy to a child.

Not suitable for children under 3 years due to small parts that could be swallowed.

Conforms to product safety standards ASTM F963.

Keep instructions for future reference. Do not discard.

Google Play and the Google Play logo are trademarks of Google Inc.

Apple and the Apple logo are trademarks of Apple Inc., registered in the U.S. and other countries. App Store is a service mark of Apple Inc., registered in the U.S. and other countries.

The software included in this product contains copyrighted software that is licensed under the GPLv3. A copy of that license is included in our website at the URL below. You may obtain the complete Corresponding Source code from us for a period of three years after our last shipment of this product and/or spare parts therefor, which will be no earlier than 05-01-2020, on our website at <http://www.skyrockettoys.com/GPL/>

©2017 Skyrocket Toys LLC, Los Angeles CA 90066 USA. All Rights Reserved. Sky Viper and Skyrocket and their respective logos are trademarks and/or registered trademarks of Skyrocket Toys LLC. All other trademarks, logos and copyrights are the property of their respective owners, and there is no relationship express or implied with Skyrocket Toys LLC.

MADE IN CHINA.

SKYROCKET