

### STREAMING DRONE WITH AUTO PILOT

#### INSTALL THE SKY VIPER VIEWER APP

Download and install free **Sky Viper Video Viewer** app onto your smart phone.



#### ATTACH YOUR PHONE TO THE REMOTE

If not already assembled, attach phone mount to remote. Push upper lip of phone mount upward and insert your phone into mount as shown.



#### POWERING UP AND PAIRING DRONE TO REMOTE

Charge LiPo battery and insert into drone. Install 3 fresh 1.5V AA (LR6) batteries into remote.



1 Connect Drone LiPo battery.



2 Quickly place Drone on **FLAT LEVEL SURFACE**, with an unobstructed view to the sky



3 Press the power button to turn controller ON.



4 Wait for flashing green light to turn solid.

#### CONNECTING DRONE TO SMART PHONE

1. Go to the Wi-Fi settings on your device and select SKYVIPERGPS\_XXXXXX to connect. [Name of Sky Viper network may vary]. Connection may take up to 30 seconds.
2. **Enter the Wi-Fi password: vipergps**
3. Open the **Sky Viper Video Viewer** App on your device

#### ACQUIRING GPS LOCK

**⚠ WARNING: GPS MODE SHOULD ONLY BE USED OUTDOORS**



1 The frame will start to acquire GPS satellites. During this time, the GPS MODE LED will blink.



2 When enough satellites are locked on, the GPS MODE will illuminate a solid GREEN. The frame is now ready to fly in GPS mode.



3 Raise the throttle stick to arm the frame. The motors will spin, indicating the frame is armed. Increase throttle to lift off of the ground.



4 When flying in GPS mode, press the RETURN button to RETURN HOME. The frame will fly back to the home location and land. **RETURN HOME will ONLY work if GPS MODE is active.**

If GPS mode is taking too long to lock, you can still launch the frame while the system continues to lock. Simply raise the throttle stick while the device continues to lock on to the GPS signal. Indoor LED will blink while you are flying without GPS lock, and will turn off once GPS lock is established. **CAUTION: In this case, your HOME LOCATION will start where the GPS MODE is obtained. This may not be near your launch location.**

Press RETURN a second time to CANCEL the RETURN HOME action.

#### INDOOR MODE

If an open sky is not possible, the frame can be flown in INDOOR mode. To activate this mode, a tap of the MODE button will enable INDOOR MODE. The INDOOR LED will illuminate solid red to indicate this mode is active.



1 Raise the throttle stick to arm the frame. The motors will spin, indicating the frame is armed. Increase throttle to lift off of the ground.



2 When flying in INDOOR mode, the RETURN button will cause the drone to LAND at its current location.

Press RETURN a second time to CANCEL the LAND action.

#### RETURN TO HOME / LAND

- HOME LOCATION starts where GPS lock is first obtained, or can be updated from the app to your current location.
- While the drone is RETURNING TO HOME, you will still have altitude and directional control to avoid obstacles.
- While the drone is LANDING, you will still have directional control to control your exact landing location.
- Press RETURN a second time to cancel the RETURN TO HOME or LAND action.

## BASIC FLIGHT MANEUVERS (IN GPS OR INDOOR MODE)

This drone is designed to automatically maintain a hover so basic flight is easy and intuitive.

When GPS LOCK is solid, or in INDOOR mode, move the left Throttle Thumbstick up to arm the frame, and then launch the drone.



Move the left Throttle Thumbstick up and down to fly higher or lower.



Move the Directional Thumbstick in the direction you want to fly.

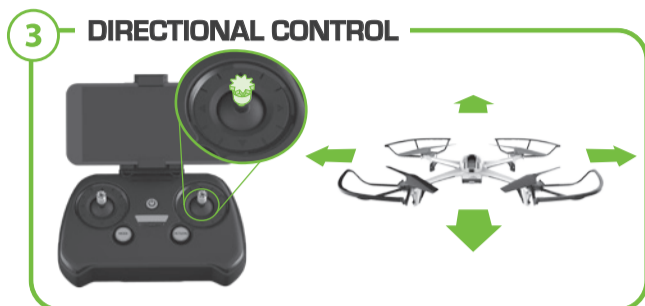

Press RETURN button to return home in GPS Mode or land in INDOOR Mode. You can also land the drone manually by holding the left thumbstick down.



## STREAMING AND RECORDING VIDEO

- Stream live video from your drone's point of view as you fly. Simply follow the in-app instructions for streaming video.
- Record video or take pictures during your flight using the on-screen recording buttons or the Photo or Video buttons located on your flight controller. See app for details.
- Higher quality video and pictures can be recorded directly to the micro SD memory card located inside the drone. Once video has been recorded and you have completed your flight, the video files can be downloaded to your smart device through the drone's Wi-Fi connection. Videos can also be downloaded directly by removing the Micro SD card from the drone and inserting into a personal computer. See app for details regarding recording and Micro SD card.



Micro SD slot is located on the back of drone. Insert card pin side up.

## FLIGHT CONTROLS

**THROTTLE/ROTATION STICK**

- Push throttle stick up to arm the drone. Motors will slowly spin.
- Once armed, push the throttle stick up to make the drone lift.
- The further you push the throttle stick, the faster you lift.

**DIRECTION STICK**

- Move the direction stick to fly forward in the direction of the green front blades. Move backwards to fly backward. The further you push, the faster the drone will fly in that direction.
- Push the direction stick left to fly left. Push right to fly right. The further you push the faster the drone will fly sideways.

**SAFETY SHUT-OFF**

If you press the power button, the motors will shut off. To reactivate, turn off remote and unplug battery from drone, then restart both as instructed in Powering Up and Pairing.

**SWITCH BETWEEN GPS MODE / INDOOR MODE**

\*GPS Mode should ONLY be used outdoors

**GPS MODE: RETURN TO HOME**

When in GPS Mode, pressing the RETURN button will instruct the drone to return to the home location. HOME LOCATION starts where GPS lock is first obtained or can be updated from the app to your current location.

**INDOOR MODE: LAND**

When in INDOOR Mode, pressing the RETURN button will instruct the drone to land immediately at its current location.

## FLYING TIPS

- Pulling the throttle backwards will reduce power and the drone will descend.
- When launching the drone, face the same direction as the drone faces. Green blades face forward.
- Practice launching, hovering and landing before attempting to learn other moves.
- Flying 2 to 3 feet above the ground will reduce ground turbulence and make flying easier.
- When first attempting to fly in different directions, start by tapping the direction stick until you have a feel for it. Always move controls slowly until you become comfortable operating the drone.
- Once you've mastered flying in directions, practice rotational controls. Spin and keep drone facing the same direction as flying becomes easier and more intuitive.
- If propeller blades come in contact with another object or you crash, throttle down or land immediately to prevent possible or further damage.
- If anything prevents drone's blades from spinning or they become jammed, throttle down or land immediately. Do not attempt to fly until obstruction has been removed and damage fixed.
- Should something prevent drone's blades from spinning, drone may auto shutdown. LiPo battery will need to be unplugged then reconnected to restore flying power.
- If the drone flies too far away, beyond the control range of the remote, the drone will return to home or land to prevent the drone from flying away out of control.

## CONTENTS

- Drone
- Controller/Transmitter
- 1200 mAh 3.7V LiPo Battery
- 4 Blade Guards
- Phone Holder
- 4 Replacement Blades
- Operator Manual
- USB Charger
- Screwdriver

## REMOTE BATTERIES NOT INCLUDED

Loosen the screw in the Remote Control battery compartment door with a Phillips screwdriver and insert batteries as shown. Replace door and tighten screw.

3 x 1.5V AA(LR6)

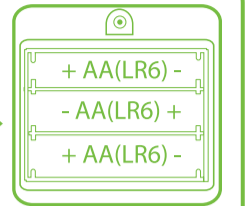
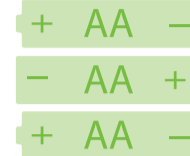

## CHARGING THE DRONE

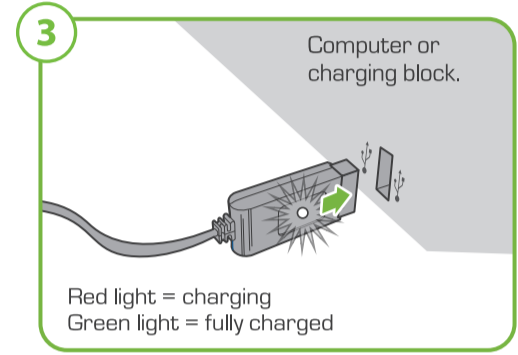
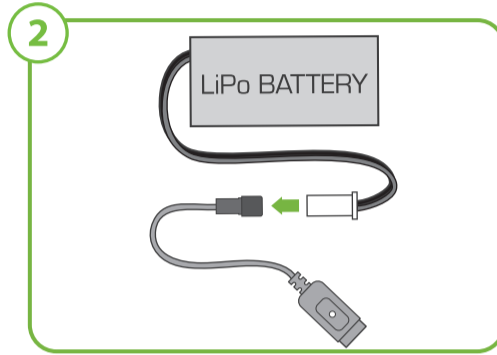

### CHARGING PRECAUTIONS:

- After use, allow the battery to cool down to room temperature before charging again.
- Charge battery in an isolated area, away from excessive heat or moisture.
- If you suspect that the battery is damaged or swelling, turn off the drone immediately.
- Do not modify, heat, or wet the battery in any way.
- Only recharge with provided charger.

## REMOVABLE BLADE GUARDS

Blade guards are recommended for inexperienced users of all ages. To attach blade guards, insert the guards to the end of each arm, under the blade.

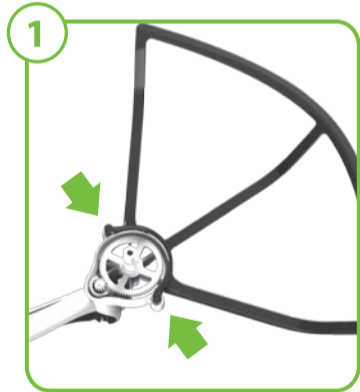

Insert blade guard pegs into holes on drone arm.

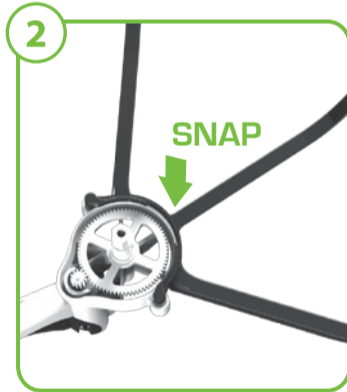

Push down on center of blade guard until you hear it "SNAP" into place.

## REPLACING DAMAGED BLADES

Use the included screwdriver to unscrew the propeller, then pull up on propeller to detach. Match A propellers to A legs and B propellers to B legs. Replace screws and tighten. See image below.

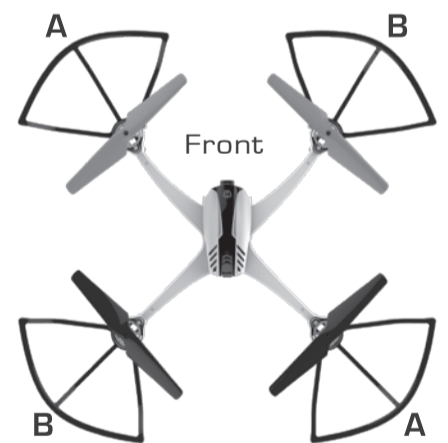
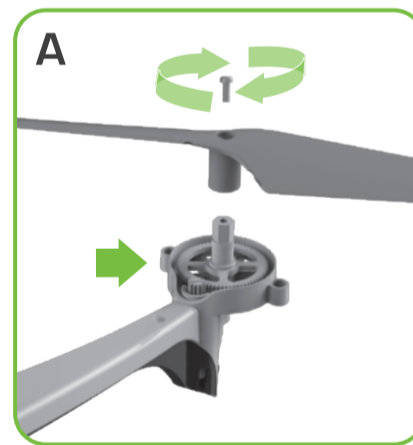

## FAILSAFE GUIDE



When the drone turns upside down, the motors will stop spinning.



When the drone goes of range of the controller, it will automatically return home/land. If the controller comes back into range before the drone lands, it is possible to cancel this automatic landing by pressing return.



When the drone's battery is depleted, the drone will automatically land itself in its current position. This automatic landing cannot be interrupted with the controller.

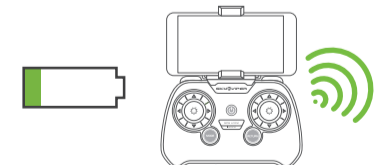

When the transmitter battery is at a critical level, it will alert with audible warning.



**WARNING:** Spinning blades can cause injury. Adequate flying space is required. Keep a safe distance away from streets, public thoroughfares, bodies of water and powerlines. Be mindful of spectators. Read all enclosed information before operating. THIS DRONE IS NOT INTENDED FOR USERS UNDER 12 YEARS OF AGE. ADULT SUPERVISION IS REQUIRED.

## ADULT SUPERVISION REQUIRED

- Before each use, an adult should check this product and the LiPo battery to ensure no damage or hazards exist.
- Make sure the drone is assembled as instructed.
- Adult supervision is recommended for drone assembly.
- Drone has rotating blades that move at high speed, posing danger of damage and injury.
- Pilots are responsible for any actions that result in damage or injury from the improper operation of drone. Adequate flying space is required.
- Avoid flying near interior fans and/or vents as they may make flying difficult to control. Keep a safe distance away from streets, public thoroughfares and power lines.
- Never attempt to retrieve drone from any location higher than your reach (such as rooftops or trees) or from any location that poses a safety hazard.
- Never fly drone at night.
- Keep drone in sight at all times during operation.
- Discontinue operation immediately if drone flies out of your field of view.
- Do not fly near spectators or animals.
- Keep spinning rotors away from loose clothing, fingers, hair, eyes and other body parts.
- Always launch from a flat surface.
- Never leave the drone unattended while it is turned on.
- Read all enclosed information before operating.
- Keep instructions for use for later reference.
- Do not touch the rotating rotor.
- Do not change or modify anything on the drone.
- Only operate under good visibility and calm weather conditions.
- Flying is strictly forbidden near high voltage poles, railway tracks, airports, roads, swimming pools, open water or large crowds of people.

### THIS PRODUCT CONTAINS A LITHIUM-POLYMER BATTERY 3.7V 1200mAh:

LiPo batteries have a severe risk of fire and injury if they are improperly handled or misused. They may explode, overheat or ignite. Read all following precautions and instructions regarding the care and use of LiPo batteries. The enclosed LiPo battery is only to be used with the drone and charger included with this product.

- Keep away from flammable materials.
- Do not expose to direct sunlight.
- Do not place in fires or leave in hot places.
- Do not drop or make subject to strong impact.
- Keep dry and away from water.
- Remove exhausted batteries as soon as possible and discard properly.
- Remove all batteries from the compartment if toy is not used for a long period.
- The supply terminals are not to be short circuited.
- Never throw batteries in a fire or attempt to open outer casing.

**LiPo Battery Disposal:** LiPo batteries must be recycled or disposed of properly. They should not be disposed of with other household waste. Check your local laws and regulations for correct recycling and/or battery disposal.

**WARNING:** Batteries are harmful if swallowed. Please keep away from children.  
**Battery Disposal:** Dispose of batteries according to the local laws and regulations of your region. Some batteries may be recycled, and may be accepted for disposal at your local recycling center. If you are not able to identify the applicable rules in your area, please check the instructions of the battery manufacturer.

### ALKALINE BATTERY CAUTIONS

- Do not use rechargeable batteries.
- Rechargeable batteries are to be removed from the toy before being charged.
- Non-rechargeable batteries are not to be recharged.
- Rechargeable batteries are only to be charged under adult supervision.
- Different types of batteries or new and old batteries are not to be mixed.
- Only batteries of the same or equivalent type as recommended are to be used.
- Batteries are to be inserted using correct polarity.
- Exhausted batteries are to be removed from the toy.
- Remove exhausted batteries as soon as possible and discard properly.
- Remove all batteries from compartment if toy is not used for a long period.
- The supply terminals are not to be short-circuited.
- Never throw batteries in a fire; battery may leak or explode.
- Never attempt to open the battery's outer casing.
- Battery should be replaced by an adult.

This device complies with PART 15 of the FCC Rules. Operation is subject to the following two conditions. (1) This device may not cause harmful interference, and (2) this device must accept any interference received, including interference that may cause undesired operation.

CAUTION: Changes or modifications to this unit not expressly approved by the party responsible for compliance could void the user's authority to operate the equipment.

NOTE: This equipment has been tested and found to comply with the limits for a Class B digital device, pursuant to Part 15 of the FCC Rules. These limits are designed to provide reasonable protection against harmful interference in a residential installation. This equipment generates, uses and can radiate radio frequency energy and, if not installed and used in accordance with the instructions, may cause harmful interference to radio communications. However, there is no guarantee that interference will not occur in a particular installation. If this equipment does cause harmful interference to radio or television reception, which can be determined by turning the equipment off and on, the user is encouraged to try to correct the interference by one or more of the following measures: Reorient or relocate the receiving antenna - Increase the separation between the equipment and receiver - Connect the equipment into an outlet on a circuit different from that to which the receiver is connected - Consult the dealer or an experienced radio/TV technician for help.

**Proudly built with open source code**  
<http://www.skyrocketon.com/open-source/>

The software included in this product contains copyrighted software that is licensed under the GPLv3. A copy of that license is included in our website at the URL below. You may obtain the complete Corresponding Source code from us for a period of three years after our last shipment of this product and/or spare parts therefor, which will be no earlier than 05-01-2020, on our website at <http://www.skyviper.com/GPL/>

Remove all packaging attachments before giving the toy to a child.  
Not suitable for children under 3 years due to small parts that could be swallowed.  
Conforms to product safety standards ASTM F963.  
Keep instructions for future reference. Do not discard.

©2017 Skyrocket LLC, Los Angeles CA 90066 USA. All Rights Reserved. Sky Viper and Skyrocket and their respective logos are trademarks and/or registered trademarks of Skyrocket LLC. All other trademarks, logos and copyrights are the property of their respective owners, and there is no relationship express or implied with Skyrocket LLC.

MADE IN CHINA. SKYROCKET 

Google Play and the Google Play logo are trademarks of Google Inc.  
Apple and the Apple logo are trademarks of Apple Inc., registered in the U.S. and other countries. App Store is a service mark of Apple Inc., registered in the U.S. and other countries.

#### WE'RE HERE TO HELP

For questions about this product:

Online: [skyviper.com/support](http://skyviper.com/support)

Phone:  
1-888-674-5650  
M-F 9am to 6pm PST

