

POWERING UP AND PAIRING (WITH ALTITUDE ON)

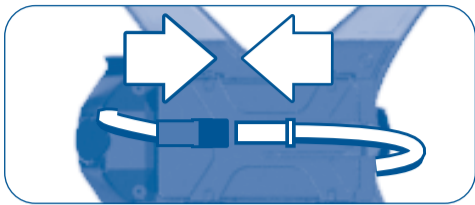

Connect battery wires on bottom of drone.

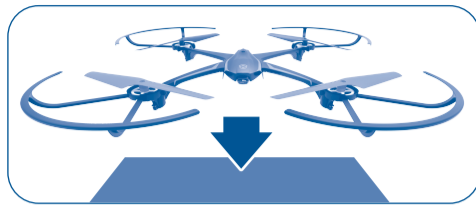

Place drone on flat surface.

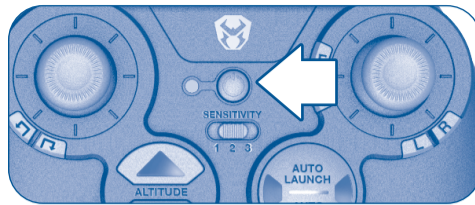

Turn on remote.

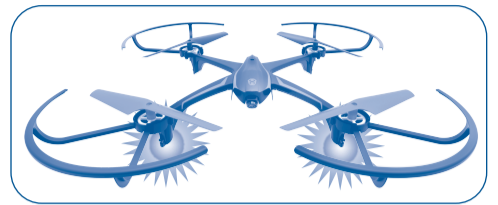

Wait for flashing green light to turn solid.

FLYING BASICS

1



Press **Auto Launch** to launch a few feet off the ground.

2



Press the **Altitude** button to fly approximately 12" higher or lower.

3

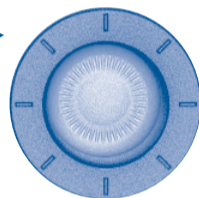

Use the directional **Thumbstick** to fly in any direction.

4



Press the **Auto Land** button to land.

TOGGLE INTO MANUAL FLIGHT BEFORE TAKE-OFF

- Hold stunt button and press auto land/auto launch button and a tone will sound from the remote. Make sure your throttle stick is in the down position.
- Push the throttle stick up to begin manual flight.

TOGGLE INTO MANUAL FLIGHT WHILE IN AUTO-HOVER

- Hold stunt button and press auto land/auto launch button and a tone will sound from the remote. Make sure your throttle stick is in the down position.
- After the tone is heard, move the throttle stick up until the drone starts to rise. (If throttle is not matched in 5 seconds then manual flight will be cancelled.)

TOGGLE INTO AUTO HOVER WHILE IN MANUAL FLIGHT

- Press either the up or down altitude locking button to toggle back into auto hover. (Your drone will hover at the current throttle speed.)

FLIGHT CONTROLS

THROTTLE/ROTATION STICK



Press up to lift



Press down to descend



Press left to rotate counter-clockwise



Press right to rotate clockwise

- While in manual flight mode push the throttle stick forward to make drone lift.
 - The further you push the throttle stick, the faster you lift.
- [Up and down controls only apply to manual flight mode.]

DIRECTION STICK

- Push the direction stick forward to fly forward or away from you (Green blade in front). Push backwards to fly backward. The further you push, the faster the drone will fly in that direction.
- Push the direction stick left to fly left. Push right to fly right. The further you push, the faster the drone will fly sideways.



Press up to fly forward



Press down to fly backward



Press left to fly left



Press right to fly right

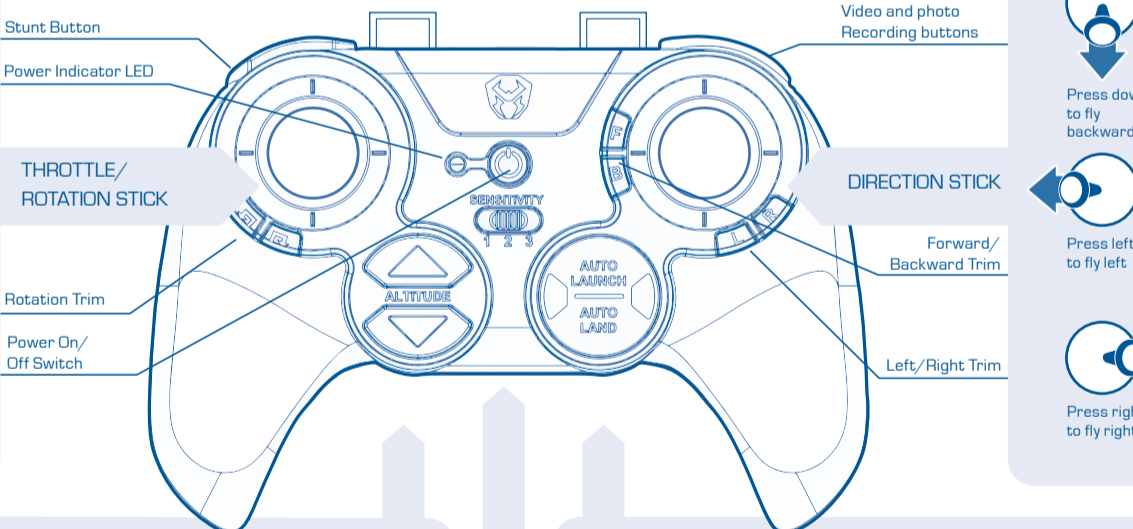

ALTITUDE BUTTONS

- Press the up or down arrow to adjust the drone's altitude. The drone will lift or lower approximately 12" each time the up or down arrow is pressed. [Distance may vary.]
- Hold the up or down buttons for continuous lift or descent.

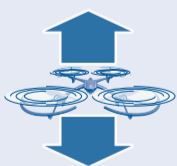

AUTO LAUNCH/LAND BUTTON

- Press the auto launch button to launch a few feet from the ground. [Exact height may vary.]
- Press the auto land button to land the drone by itself.



FLIGHT SENSITIVITY SWITCH

The Drone's responsiveness may be adjusted on the controller to match your flying skills. There are three options: 1 LOW sensitivity 2 MEDIUM sensitivity 3 HIGH sensitivity. It is best to start in the low sensitivity position until you have mastered flying. Flight sensitivity can be adjusted before or during flight.



FLYING TIPS

- When launching the drone, face the same direction as the drone. Green blades and green LEDs should be in front.
- If your drone drifts in any direction when you are hovering, you will need to make Trim adjustments to correct the driving. Trim adjustments are sometimes needed when the drone is first flown after purchase. See TRIM ADJUSTMENTS section for details.
- Practice launching, hovering and landing before attempting to learn other moves.
- Flying 2 to 3 feet above the ground will reduce ground turbulence and make flying easier.
- When first attempting to fly in different directions, start by tapping the direction stick until you have a feel for it. Always move controls slowly until you become comfortable operating the drone.
- Once you've mastered flying in directions, practice rotational controls. Spinning and keeping drone facing the same direction as you makes flying easier and more intuitive.
- Stay 2 to 3 feet away from walls and ceilings as drone will be drawn towards them if you fly too close.
- If propeller blades come in contact with another object or you crash, throttle down or auto land immediately to prevent possible or further damage.
- If anything prevents drone's blades from spinning or they become jammed, throttle down or auto land immediately. Do not attempt to fly until obstruction has been removed and damage fixed.
- Should something prevent drone's blades from spinning, drone may auto shutdown. LiPo battery will need to be unplugged then reconnected to restore flying power.
- If the drone flies too far away, beyond the control range of the remote, the drone will auto-land to prevent the drone from flying away out of control.

Online Video Instructions & Flying Tips available now at SKYVIPER.COM

STREAMING AND RECORDING VIDEO

ATTACHING YOUR DEVICE

1. Install the device holder to remote.
2. Pull the device holder arm.
3. Insert a smart device (Devices larger than 3-1/8" wide can be used but cannot be attached to remote).

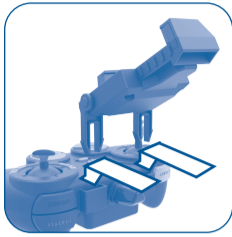

LIVE STREAMING AND RECORDING

1. Plug in battery on drone.
2. Go to **Wi-Fi network** list on your smart device.
3. Select a connection similar to SKYVIPER_ABC123 and connect. (Note: May take up to 30 seconds to connect.)
4. Enter the password: **viper**
4. Open the **Sky Viper Video Viewer** app on your device.
5. Follow the on-screen icons to connect with your drone. Once connected you can record video and take photos on your device.
6. You can initiate recording by pressing the control buttons on your remote.

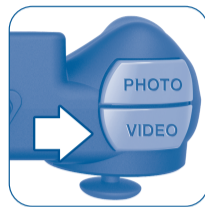

Download the **Sky Viper Video Viewer** app for free. The app is required for streaming.



RECORDING TO MICRO SD CARD

(SOLD SEPARATELY)

If you are connected to a smart device through WiFi and wish to record to Micro SD instead of your device, you can change the recording setting through the Sky Viper Viewer app. If you are not connected to a smart device, recording will be redirected to Micro SD automatically.

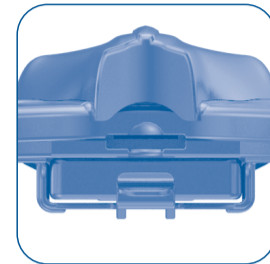

Micro SD slot is located on back of drone. (card sold separately)

TRIM ADJUSTMENTS

If the drone drifts in any direction while hovering (and you are not pressing the direction stick), you may need to make trim adjustments.

Press the recommended trim button as described below to make adjustments.

Tip 1: When the remote LED flashes 3 times quickly, the trim will revert back to middle of trim range.

Tip 2: If you are uncomfortable trimming the drone in flight, you can land onto a flat surface and make your trim adjustments.

NOTE:

Trim adjustments will remain saved until remotes batteries are removed.

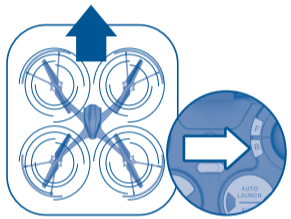

If the drone drifts forward
- Press B button

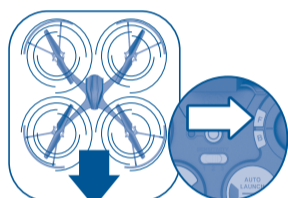

If the drone drifts backwards
- Press F button

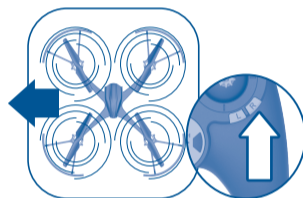

If the drone drifts left
- Press R button

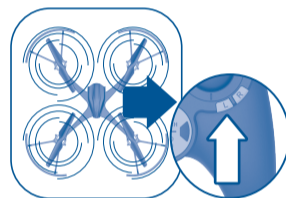

If the drone drifts right
- Press L button

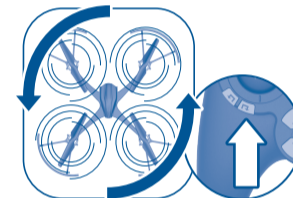

If the drone spins counter-clockwise, when viewed from the top
- Press R button

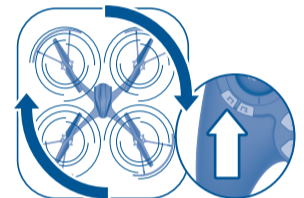

If the drone spins clockwise, when viewed from the top
- Press L button

TROUBLESHOOTING

PROBLEM	SOLUTION
Drone drifts in any direction during flight without direction from the remote	<ul style="list-style-type: none"> Adjust the trim controls until drifting ceases.
All blades spin, but drone will not fly properly or crashes immediately	<ul style="list-style-type: none"> Drone's blade may have been installed incorrectly. Reinstall and remember that the GREEN blades point forward.
Drone is unresponsive	<ul style="list-style-type: none"> Ensure the remote has fresh batteries and the LiPo battery is fully charged. Drone may be miscalibrated by launching from an un-level surface. Turn the remote off. Turn off the drone then turn them back on and try again from a flat, level launching surface. Inspect drone for any possible damage.
Drone crashes when attempting stunt functions	<ul style="list-style-type: none"> Ensure that drone is flying a minimum distance of 6 feet from the ground with a minimum 6 feet clearance in all directions.

ONE TOUCH STUNTS

BARREL ROLL

While flying forward (or reverse), tap the stunt button.

NOTE:

Once a stunt has been initiated, DO NOT adjust Throttle or press any other controls until the stunt has been completed.

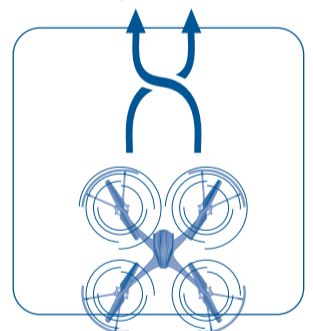
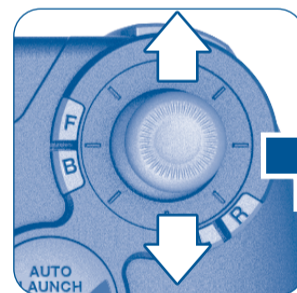

FLIP

1 Bring the drone to a mid-air hover without flying in any direction. Remove finger from the direction stick.

2 While hovering, tap and hold the stunt button.

3 Then quickly tap the direction stick in the direction you want the drone to flip.

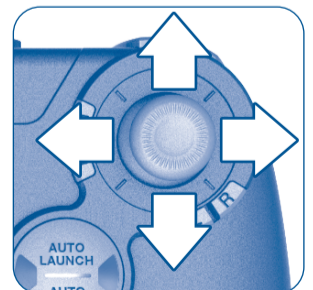
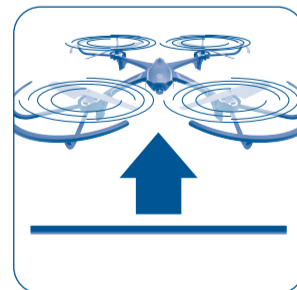

CAUTION!

The drone should be flying at least 6 feet in the air with a minimum clearance of 6 feet in all directions before attempting stunt functions.

ADULT SUPERVISION REQUIRED

Before each use, an adult should check this product and the LiPo battery to ensure no damage or hazards exist. Drone has rotating blades that move at high speed, posing danger of damage and injury. Pilots are responsible for any actions that result in damage or injury from the improper operation of drone. Adequate flying space is required. Avoid flying near interior fans and/or vents as they may make flying difficult to control. Keep a safe distance away from streets, public thoroughfares and power lines. Never attempt to retrieve drone from any location higher than your reach (such as rooftops or trees) or from any location that poses a safety hazard. Never fly drone at night. Keep drone in sight at all times during operation. Discontinue operation immediately if drone flies out of your field of view. Do not fly near spectators or animals. Keep spinning rotors away from fingers, hair, eyes and other body parts. Always launch from a flat surface. Never leave drone unattended while it is turned on. Read all enclosed information before operating.

STREAMING VIDEO DRONE

CONTENTS

- Streaming Video Drone
- Alternative Pro Thumbsticks
- Screwdriver
- Rechargeable 3.7v 650mAH LiPo Battery
- Screws
- Remote Control
- 4 Blade Guards
- 4 Replacement Blades
- USB Charging Cable
- Phone Mount

REMOTE BATTERIES

Loosen the screw in the Remote Control battery compartment door with a Phillips screwdriver and insert batteries as shown. Replace door and tighten screw.

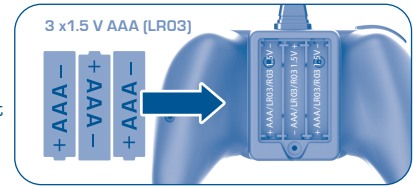

CHARGING THE DRONE

- 1 Disconnect battery wires. Push down the battery box holder on the rear side of the drone. Pull battery box out of underside of drone.
- 2 Plug charging cord into computer or USB power block. Once charged, disconnect battery from USB charging cable.
- 3 Insert LiPo battery into back of drone. Reconnect the battery wires.

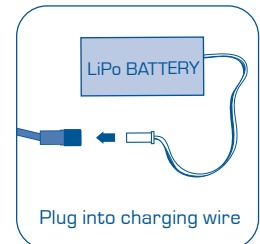
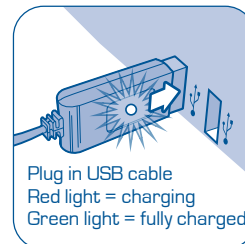
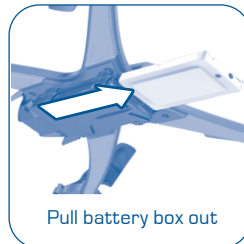
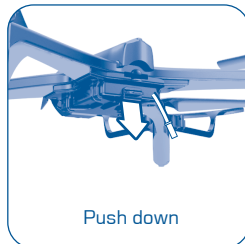
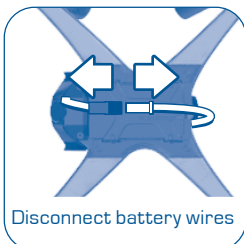

CHARGING PRECAUTIONS:

- After use, allow drone (battery on bottom) to cool down to room temperature before charging again.
- Charge drone in an isolated area, away from excessive heat or moisture.
- If you suspect that the battery is damaged or swelling, turn off the drone immediately.
- Do not modify, heat, or wet the battery in any way. Only recharge with provided charger.

OPTIONAL BLADE GUARDS

Blade guards are great for beginning pilots and can be easily installed if desired. **The guards add undesired weight and reduce flight performance. Blade guards are optional and should not be used with advanced flight sensitivity setting 3.** To attach blade guards, insert the posts of the blade guards into the holes of the drone. Press in the posts to lock into place.

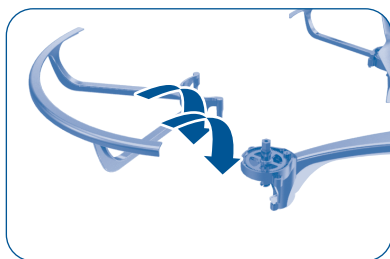

REPAIRING DAMAGED BLADES

- 1 Unplug battery on drone.
- 2 Make note of the blade color and letter (A or B) before removing the blade from drone. (Markings are located on the underside of blades and Drone).
- 3 Remove the small screw using the mini screwdriver provided.
- 4 Replace the damaged blade with a new blade with matching color and letter. Secure the blade with the retaining screw.

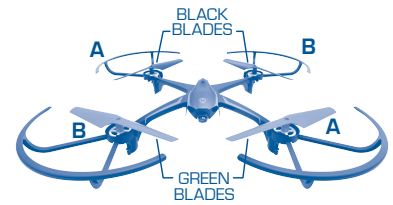
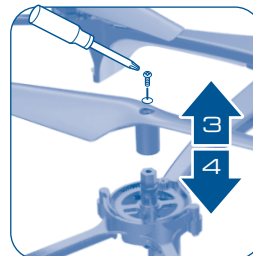

MAINTENANCE

- Over time, loose hair or carpet fibers may get wound in blades, reducing performance. Unplug the Drone and remove fibers from motors. (Remove blades if necessary)

ALTERNATIVE PRO THUMBSTICKS

- Lift joystick upward to remove.
- Insert thumbstick into stem to replace.

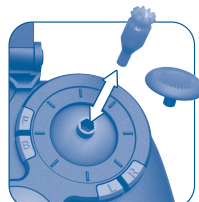

Online Video Instructions & Flying Tips available now at SKYVIPER.COM

DOWNLOAD THE SKY VIPER FLIGHT SIMULATOR APP ON YOUR DEVICE

Learn and practice maneuvers on your phone, then apply your new skills in real life.

- Download the Sky Viper Flight Simulator app for free!
- Auto & Manual Flight Modes
- Practice & Challenge Simulations
- 1st and 3rd Person Views
- Choose from the entire Sky Viper fleet



BATTERY REPLACEMENT

Double your flying time with a 2nd battery! Details of how to purchase additional or replacement battery packs available at SKYVIPER.COM



THIS PRODUCT CONTAINS A LITHIUM-POLYMER BATTERY 3.7V 650mAh:

LiPo batteries have a severe risk of fire and injury if they are improperly handled or misused. They may explode, overheat or ignite. Read all following precautions and instructions regarding the care and use of LiPo batteries.

The built-in LiPo battery is only to be used with the drone and charger included with this product.

- Keep away from flammable materials.
- Do not expose to direct sunlight.
- Do not place in fires or leave in hot places.
- Do not drop or make subject to strong impact.
- Keep dry and away from water.
- Remove exhausted batteries as soon as possible and discard properly.
- Remove all batteries from the compartment if toy is not used for a long period.
- The supply terminals are not to be short circuited.
- Never throw batteries in a fire or attempt to open outer casing.

LiPo Battery Disposal: LiPo batteries must be recycled or disposed of properly. They should not be disposed of with other household waste. Check your local laws and regulations for correct recycling and/or battery disposal.

ALKALINE BATTERY CAUTIONS

- Do not use rechargeable batteries.
- Different types of batteries or new and old batteries are not to be mixed.
- Batteries are to be inserted using correct polarity.
- Remove exhausted batteries as soon as possible and discard properly.
- Remove all batteries from compartment if toy is not used for a long period.
- Never throw batteries in a fire or attempt to open the outer casing.

WARNING: Batteries are harmful if swallowed. Please keep away from children.

Battery Disposal: Dispose of batteries according to the local laws and regulations of your region. Some batteries may be recycled, and may be accepted for disposal at your local recycling center. If you are not able to identify the applicable rules in your area, please check the instructions of the battery manufacturer.

This device complies with PART 15 of the FCC Rules. Operation is subject to the following two conditions. (1) This device may not cause harmful interference, and (2) this device must accept any interference received, including interference that may cause undesired operation.

CAUTION: Changes or modifications to this unit not expressly approved by the party responsible for compliance could void the user's authority to operate the equipment.

NOTE: This equipment has been tested and found to comply with the limits for a Class B digital device, pursuant to Part 15 of the FCC Rules. These limits are designed to provide reasonable protection against harmful interference in a residential installation. This equipment generates, uses and can radiate radio frequency energy and, if not installed and used in accordance with the instructions, may cause harmful interference to radio communications. However, there is no guarantee that interference will not occur in a particular installation. If this equipment does cause harmful interference to radio or television reception, which can be determined by turning the equipment off and on, the user is encouraged to try to correct the interference by one or more of the following measures: Reorient or relocate the receiving antenna - Increase the separation between the equipment and receiver - Connect the equipment into an outlet on a circuit different from that to which the receiver is connected - Consult the dealer or an experienced radio/TV technician for help.

Remove all packaging attachments before giving the toy to a child.

Not suitable for children under 3 years due to small parts that could be swallowed.

Conforms to product safety standards ASTM F963.

Keep instructions for future reference. Do not discard.



©2016 Skyrocket Toys LLC, Los Angeles CA 90066 USA. All Rights Reserved. Sky Viper and Skyrocket and their respective logos are trademarks and/or registered trademarks of Skyrocket Toys LLC. All other trademarks, logos and copyrights are the property of their respective owners, and there is no relationship express or implied with Skyrocket Toys LLC.

MADE IN CHINA.



The software included in this product contains copyrighted software that is licensed under the GPLv3. A copy of that license is included in our website at the URL below. You may obtain the complete Corresponding Source code from us for a period of three years after our last shipment of this product and/or spare parts therefor, which will be no earlier than 05-01-2019, on our website at <http://www.skyrockettoys.com/GPL/>